

Bag filter housing BF-PPH



The bag filter housing BF-PPH is made of glasfiber reinforced polypropylene. It is extremely resistant to hydrochloric and sulfuric acids, seawater, alcohols and concentrated alkalis. The screw-on housing lid ensures a fast and easy way to replace the used filter bags.

The maximum working pressure of 10 bar and the maximum working temperature of 110°C are extraordinary at this kind of housing.

The high working pressure and working temperature combined with the resistance to a lot of mediums ensures a wide range of applications.

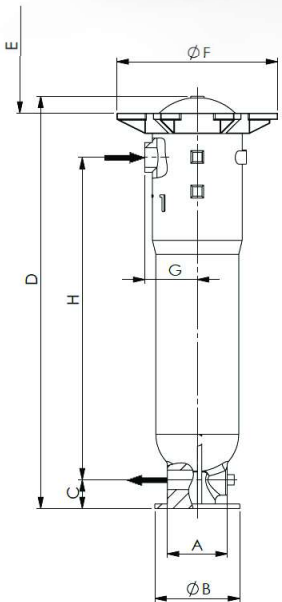

| Type | A | B | C | D | E | F | G | H |
|---------|-----|-----|----|------|-----|-----|-----|------|
| BF-PPH1 | 165 | 254 | 83 | 815 | 510 | 467 | 156 | 607 |
| BF-PPH2 | 165 | 254 | 83 | 1221 | 920 | 467 | 156 | 1013 |

Technical data

| | BF-PPH1 | BF-PPH2 |
|--|---|---------------------|
| Material: | Polypropylene glasfiber reinforced | |
| Volume: | 25 Liter | 36 Liter |
| Filter surface: | 0,25 m ² | 0,50 m ² |
| In-/Outlet: | 2" female thread or DN50 screw-in flange | |
| Drain: | 2" female thread (standard closed with plug) | |
| Vent: | 5/8" UNC (Vent with G1/4" BSP DIN 228-1 enclosed) | |
| Working pressure: | max. 10 bar @ 20 °C | |
| Working temperature: | max. 110 °C @ 4,5 bar | |
| Gasket: | Viton | |
| Manufactured acc. to the pressure equipment directive (2014/68/EU) article 4, p. 3 | | |

Order information

| | | | |
|--------|-----------------|------------------|---|
| BF-PPH | | - | |
| | Filter bag size | Connection | |
| | 1 | 2" female thread | |
| | 2 | DN50 | Screw-in flange DN50 (enclosed for self installation) |

Order example: BF-PPH2-DN50